

Hall 1: 14m x 10.8m (151.2 m²)
 Hall 2: 7.5m x 4.6m (34.5 m²)
 Total approximate ground floor area: 385m²

Buildings to be replaced

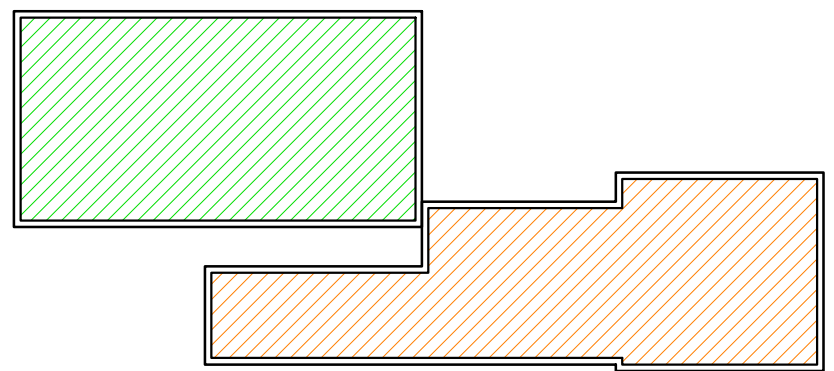

Baden Lodge floor area: 171m²
 Pavilion floor area: 179m²

Total combined areas: 735m²

Proposed Community Centre

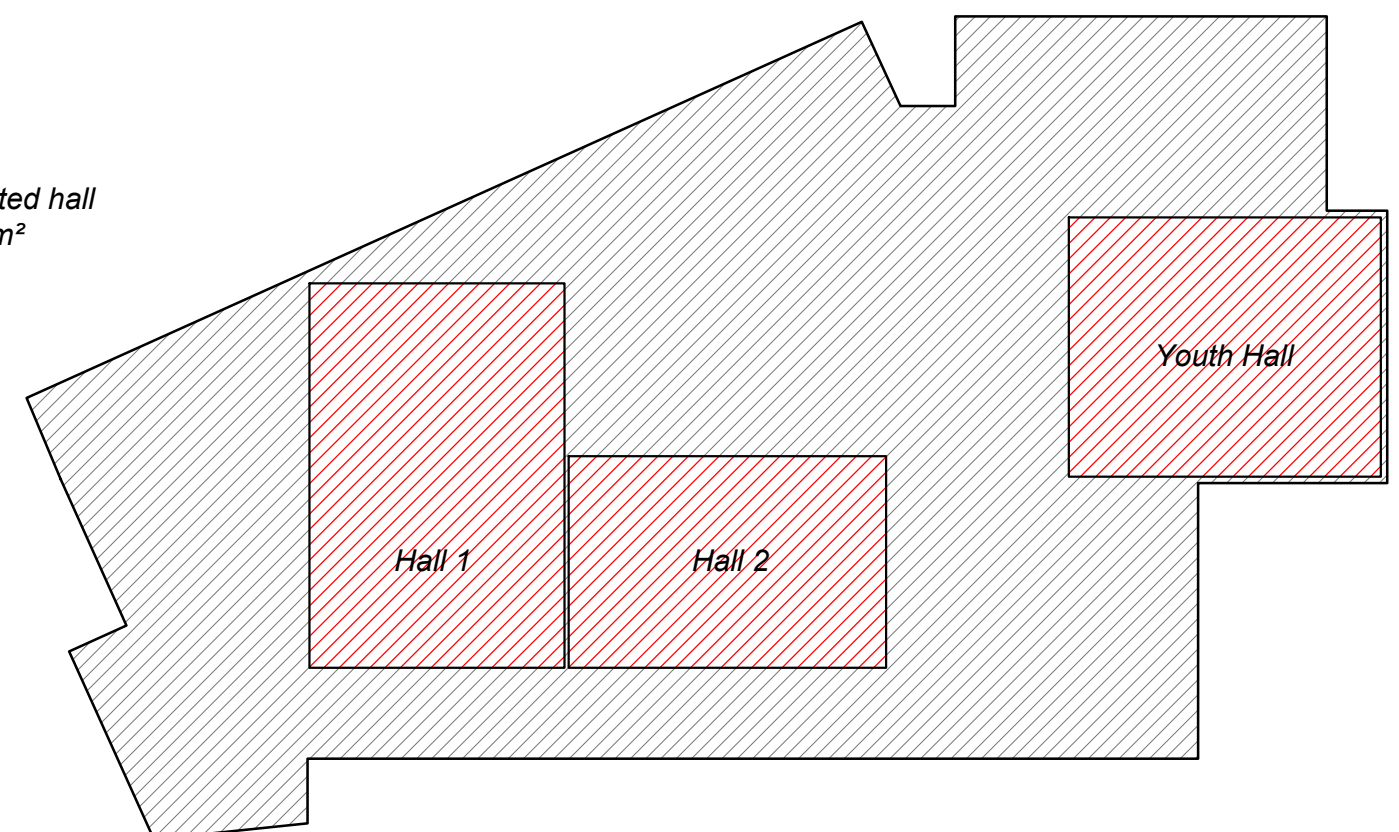

Hall 1: 17.8m x 11.8m (210 m²)
 Hall 2: 14.7m x 9.8m (144m²)
 Youth Hall: 14.5m x 12m (174 m²)

Total Ground Floor Area: 1,650m²

Total dedicated hall area: 535.7m²

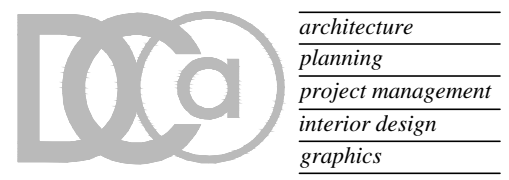

David Coles architects www.colesarchitects.co.uk
 1 Cobbs Court, High Street, Olney, Buckinghamshire MK46 5QN
 t:01234 241758 f:01234 711459 e:proactive@colesarchitects.co.uk

NOTE: NO DIMENSIONS TO BE SCALED FOR CONSTRUCTION. DRAWINGS MAY BE SCALED FOR PLANNING PURPOSES ONLY. ALL DIMENSIONS TO BE CHECKED ON SITE. COPYRIGHT RESERVED.

REV: | BY: | DATE: | DETAILS:

PROJECT: **Community & Youth Facility HANSLOPE**
 CLIENT:

ISSUE STATUS:
 DESIGN B of Q CONSTRUCTION RECORD

DRAWING TITLE: **Area Comparison Sheet**

SCALE: **1:350@A3** DATE: **Oct 11** BY: **AT**
 DRAWING NO: REVISION:

11026 (B) 111